

INSTALLATION INSTRUCTIONS

Silo Pendant - Replacement Collar

WAC LIGHTING

M2015-C, M2020-C

CAUTION: TO PREVENT ELECTRICAL SHOCK, ENSURE ELECTRICITY HAS BEEN TURNED OFF AT THE CIRCUIT BREAKER BEFORE BEGINNING.

- Read all instructions before installing.
- System is intended for installation by a licensed electrician in accordance with the National Electrical Code (NEC) and local regulations.
- When handling the fixture, do not apply pressure to the LEDs. Hold the fixture by the base only.
- Retain installation instructions for future maintenance reference.

WARNING: All parts must be used as indicated in these instructions. This product is designed for use only with the supplied parts and/or accessories designated for use by WAC Lighting. Substitution of parts or accessories not designated for use with this product by WAC Lighting could result in personal injury or property damage, and will void the warranty. Contact an authorized dealer or the manufacturer if any parts are damaged or missing.

MAINTENANCE NOTE: Coastal conditions may cause mineral and residue build-up on the fixture. We recommend that customers in coastal areas clean all external surfaces of the fixture once every two weeks with a wet cloth.

MISE EN GARDE: POUR ÉVITER TOUT CHOC ÉLECTRIQUE, ASSUREZ-VOUS QUE LE DISJONCTEUR SOIT MIS HORS TENSION AVANT DE COMMENCER.

- Lisez toutes les instructions avant l'installation.
- Le système doit être installé par un électricien licencié conformément au code national de l'électricité (NEC), et également aux règlements locaux.
- Lors de la manipulation du luminaire, n'appuyez pas sur les LED. Tenez-le uniquement par la base.

ATTENTION: Toutes les pièces doivent être utilisées comme indiqué dans ces instructions. Ce produit est conçu pour être utilisé seulement avec les pièces et/ou accessoires fournis pour être utilisés avec les produits WAC Lighting. Remplacer des pièces ou accessoires non conçus pour ce produit WAC Lighting pourrait causer des dommages corporels ou matériels et pourrait également causer l'annulation de la garantie. Veuillez contacter un revendeur autorisé ou le fabricant si des pièces manquent ou sont endommagées.

NOTE D'ENTRETIEN: Les conditions côtières peut causer une accumulation de minéraux et de résidus sur le luminaire. Nous recommandons aux clients qui résident dans les zones côtières de nettoyer toutes les surfaces externes du luminaire une fois toutes les deux semaines avec un chiffon humide.

COMPONENT OVERVIEW

Replacement Collars: M2015-C & M2020-C are intended for installation to existing Silo Pendant fixtures.

OVERALL COMPONENT DIMENSIONS

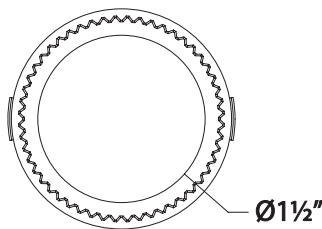
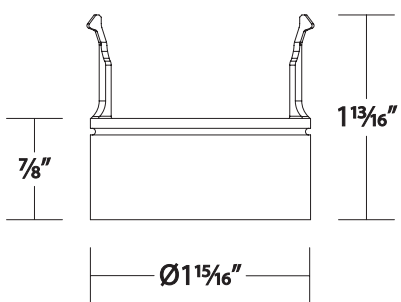

M2015-C

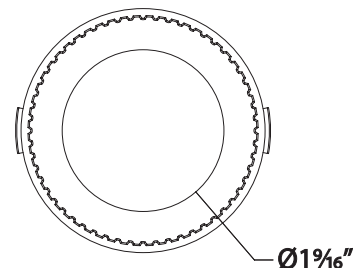
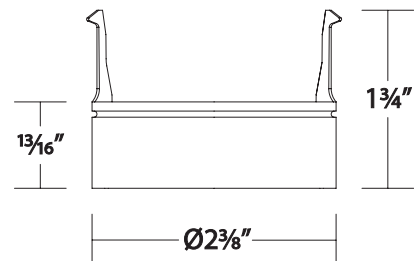

M2020-C

waclighting.com
Phone (800) 526.2588
Fax (800) 526.2585

Headquarters/Eastern Distribution Center
44 Harbor Park Drive
Port Washington, NY 11050

Central Distribution Center
1600 Distribution Ct
Lithia Springs, GA 30122

Western Distribution Center
1750 Archibald Avenue
Ontario, CA 91760



INSTALLATION INSTRUCTIONS

Silo Pendant - Replacement Collar

WAC LIGHTING

M2015-C, M2020-C

REPLACING THE COLLAR (FOR PD-2015 & H/L/J-PD2015):

The beam adjustment collar may be replaced in field to change the decorative appearance of the fixture.

1. Power off the fixture and allow it to cool down.
2. Pull the collar down to its extended position. Using additional force, continue to pull the collar to remove it from the fixture (See **FIG. 1**).
3. Align the replacement collar with the groove of the beam changing mechanism and install to fixture (See **FIG. 2 & 3**).

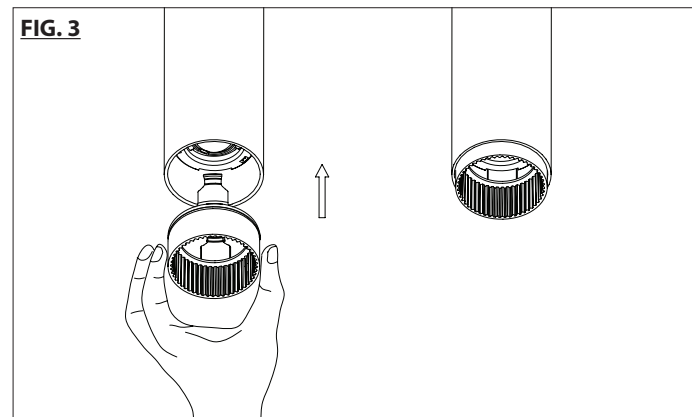
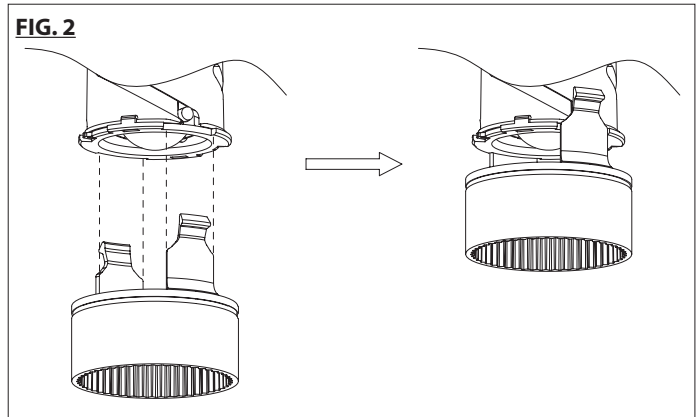
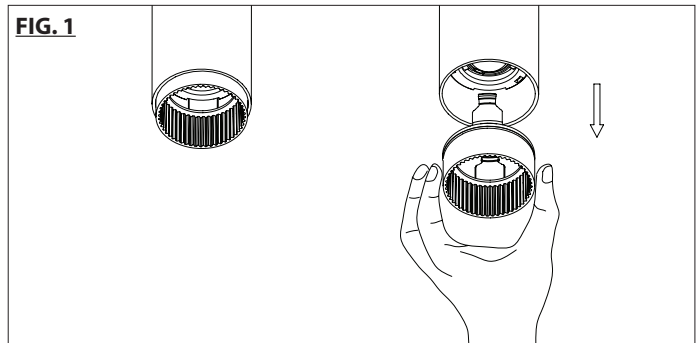

REPLACING THE COLLAR (FOR PD-2020 & H/J/L-PD2020):

The beam adjustment collar may be replaced in field to change the decorative appearance of the fixture.

1. Power off the fixture and allow it to cool down.
2. Pull the collar down to its extended position. Using additional force, continue to pull the collar to remove it from the fixture (See **FIG. 4**).
3. Align the replacement collar with the groove of the beam changing mechanism and install to fixture (See **FIG. 5 & 6**).

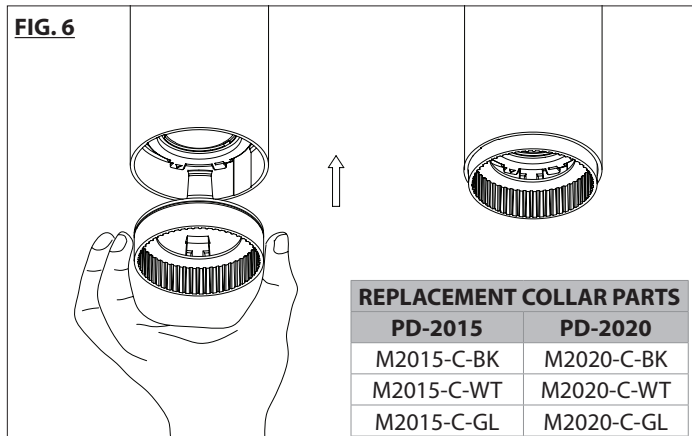
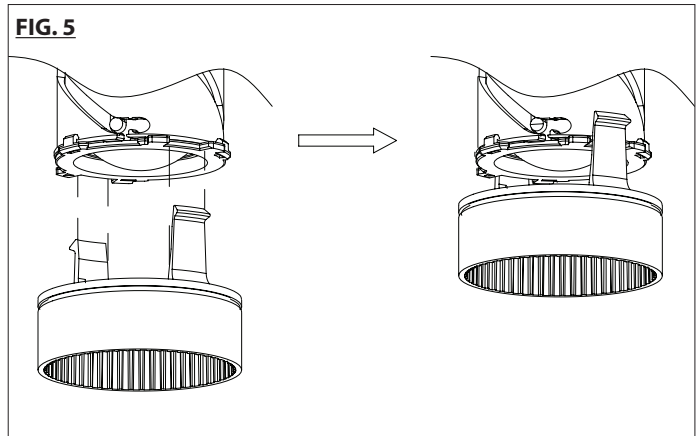
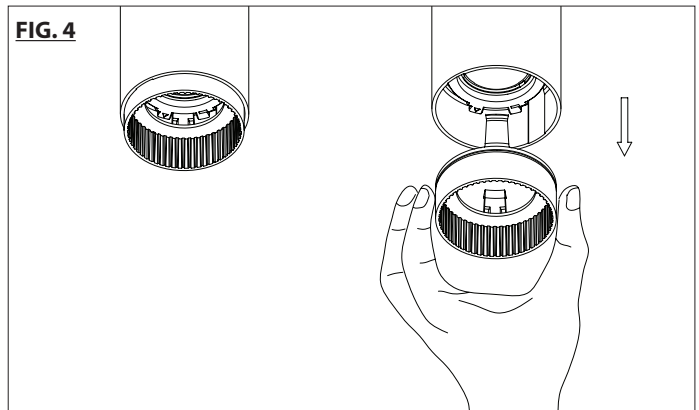

wacighting.com
Phone (800) 526.2588
Fax (800) 526.2585

Headquarters/Eastern Distribution Center
44 Harbor Park Drive
Port Washington, NY 11050

Central Distribution Center
1600 Distribution Ct
Lithia Springs, GA 30122

Western Distribution Center
1750 Archibald Avenue
Ontario, CA 91760

