

INSTALLATION INSTRUCTION

AETHER ATOMIC - TRIMLESS ADJUSTABLE

R1ARARL, R1ASARL, R1ABFL



WARNING:

IMPORTANT: NEVER attempt to do any work without shutting off the electricity.

- Read all instructions before installing.
- System is intended for installation by a qualified electrician in accordance with the National Electrical Code and local regulations.
- Go to the main fuse box, or circuit breaker. Place the main power switch in the "OFF" position and unscrew the fuse(s) or switch "OFF" the circuit breaker switch(es) that control the power to the fixture or room that you are working on.
- Place the wall switch in the "OFF" position.

AVERTISSEMENT:

IMPORTANT: Coupez l'électricité avant TOUTE manipulation.

- Lisez toutes les instructions avant d'installer.
- Système est destiné à être installé par un électricien qualifié en conformité avec le code national de l'électricité et les règlements locaux.
- Accédez au panneau central de disjoncteurs ou de fusibles de votre demeure et placez l'interrupteur principal en position d'arrêt (« OFF »).
- Placez l'interrupteur mural en position d'arrêt (« OFF »).

CAUTION:

All parts must be used as indicated in these instructions. Do not substitute any parts, leave parts out, or use any parts that are worn out or broken. Failure to follow this instruction could invalidate the ETL/cETL listing of this fixture.

OVERVIEW:

Housing is for IC remodel and new construction applications. Housing requires a remote power supply to power the LED and a trim for a finished look. Refer to specification sheets for compatible remote power supply and trim options .

OVERALL HOUSING DIMENSION

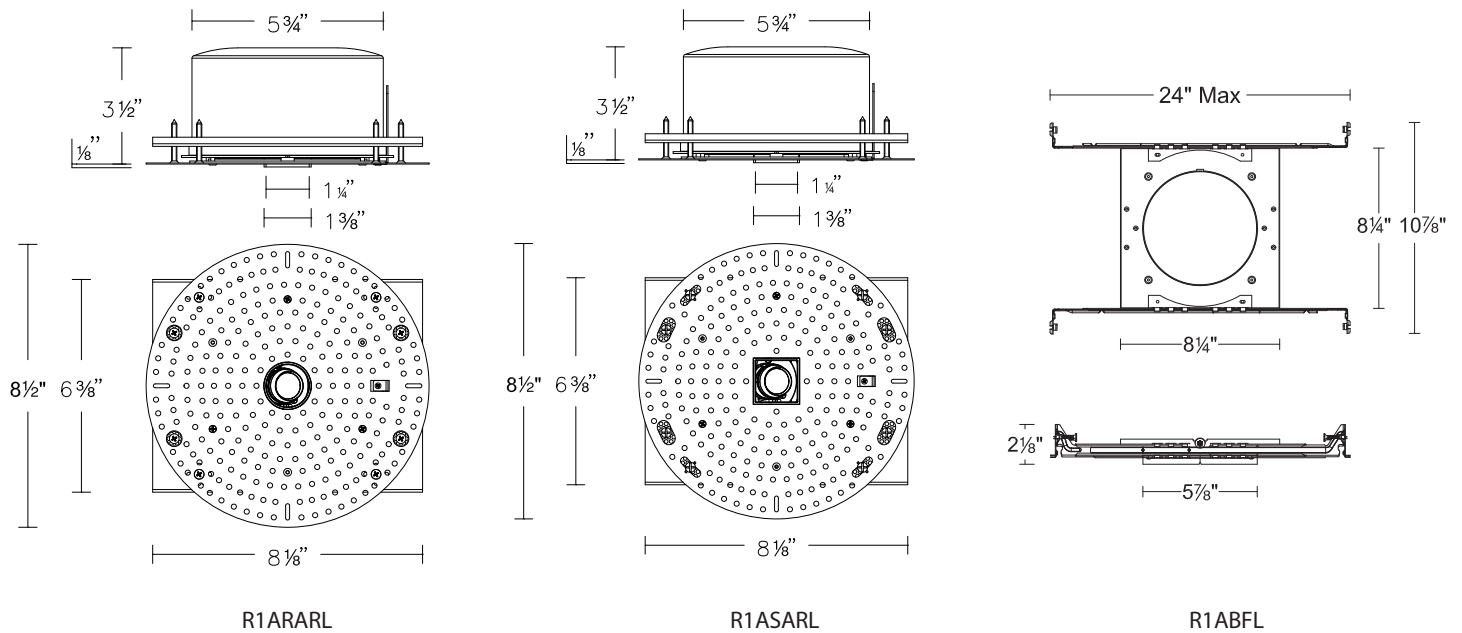

SPECIFICATIONS	
Input	DC 18V, 600mA Constant Current
Ceiling Thickness	1/2" - 2"

Installation Type	Ceiling Thickness	Minimum Required Ceiling Plenum Height
New Construction	1/2" - 2"	4"
Remodel	1/2"	4"
	1"	4 1/2"
	2"	5 1/2"

wacighting.com
Phone (800) 526.2588
Fax (800) 526.2585

Headquarters, East Manufacturing Facility
44 Harbor Park Drive
Port Washington, NY 11050

South East Manufacturing Facility
1600 Distribution Ct
Lithia Springs, GA 30122

Central Manufacturing Facility
1700 South J Elmer Freeway, Ste 100
Cedar Hill, TX 75104

West Manufacturing Facility
1750 S Archibald Ave
Ontario, CA 91761

INSTALLATION INSTRUCTION

AETHER ATOMIC - TRIMLESS ADJUSTABLE

R1ARARL, R1ASARL, R1ABFL



REMODEL INSTALLATION

1. Cut out a 6 1/2" diameter hole on drywall ceiling using a proper tool (See FIG. 1).
2. Take out the ceiling mounting plate included in the housing package. Press the plate against the ceiling from below, with the collar of the plate inserted inside the cutout hole. Center the collar about the cutout hole. (See FIG. 2).

Rotate the ceiling mounting plate along the cutout hole, using the two rectangular slots on the plate as an axis to align the plate. Draw two short lines inside the two slots using a pencil. If you are installing a square housing (R1ASARL*), these two short lines will serve as the axis to align the square downlight trim or pinhole. Mark four dots using the pencil at locations shown in Figure 2 (See FIG. 2).

3. Flip the ceiling mounting plate along the axis connecting the two slots to let the collar face downwards. Place the plate on top of the drywall ceiling by passing through the cutout hole (See FIG. 3).

4. Ensure the collar fits inside the cutout hole and is centered. Align the mounting plate's rectangular cutout and V-shaped notch with the two short lines marked on the ceiling (done in Step 2) (See FIG. 4A). Hold the plate tight against the ceiling with one hand and fasten drywall screws (included with the housing) through the four dots (marked on drywall in Step 2), into the plate above. (See FIG. 4B).

5. Take out the housing body and connect two wire leads from the remote power supply using two WAGO connectors pre-installed on housing wire leads (See FIG. 5). Refer to remote power supply instruction for fixture and dimmer wiring.

CAUTION: Do not power fixture with foam plug installed or damage may result. Remove plug and keep for future installation if wish to power at this step.

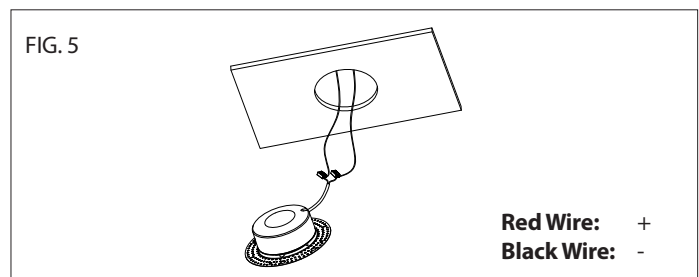
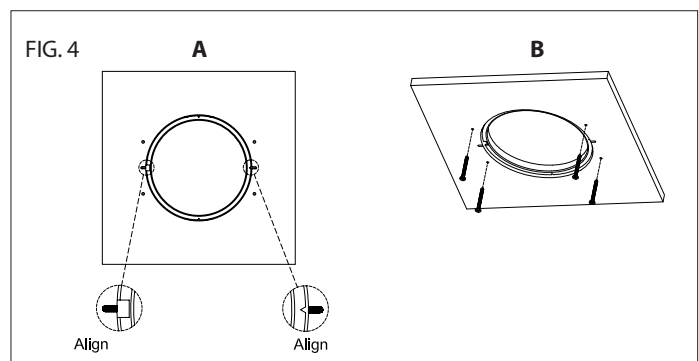
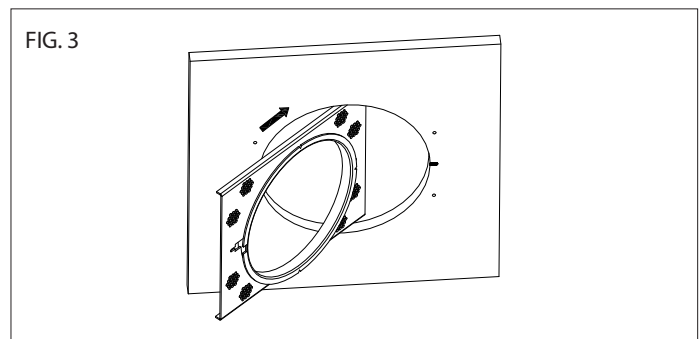
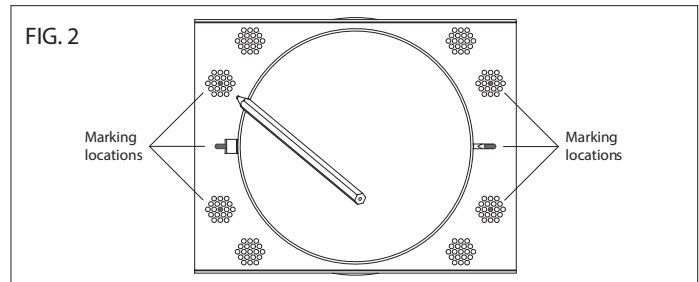
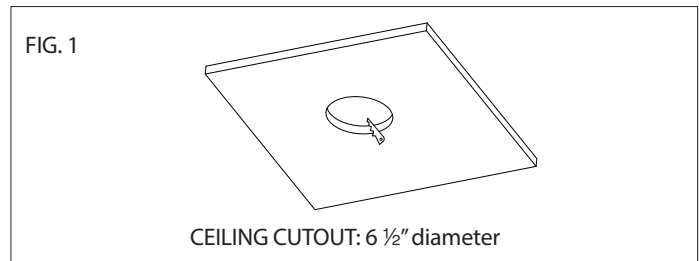

INSTALLATION INSTRUCTION

AETHER ATOMIC - TRIMLESS ADJUSTABLE

R1ARARL, R1ASARL, R1ABFL



6. Insert the housing body inside the ceiling opening and rotate the housing until the positioning pin on the housing fits inside the rectangular cutout on the ceiling mounting plate. Press the trimless frame of the housing against the ceiling and fasten four drywall screws (included with the housing) at four countersink holes (round housing, R1ARARL*) or curved slots (square housing, R1ASARL*) on the trimless frame to mount the housing to the ceiling (See **FIG. 6**).

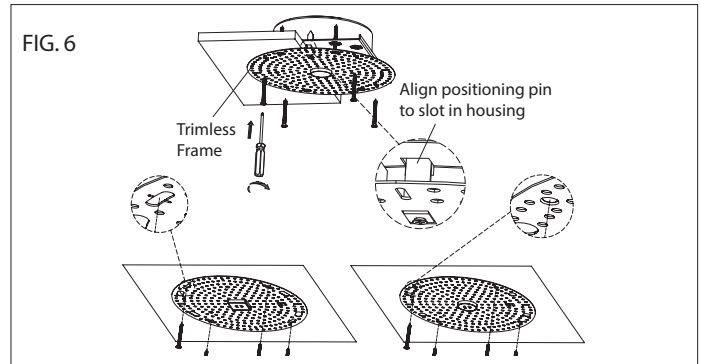

7. To make fine adjustments in alignment for square housing, use a Phillips screw driver to remove the positioning pin from the trimless frame, slightly loosen four mounting screws, and rotate the housing to achieve the desired alignment (See **FIG. 7**).

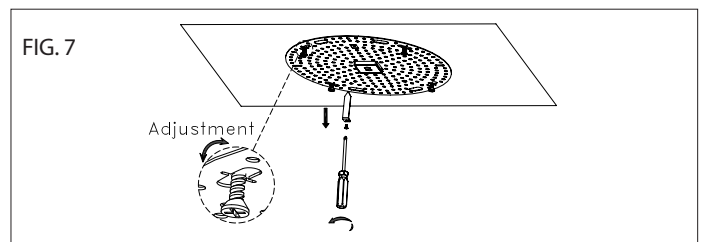

8. Ensure the foam plug covers the housing collar opening with its bottom surface flush with the collar edge. Apply plaster or spackle over trimless frame and sand surface when dry for a finished look (See **FIG. 8**).

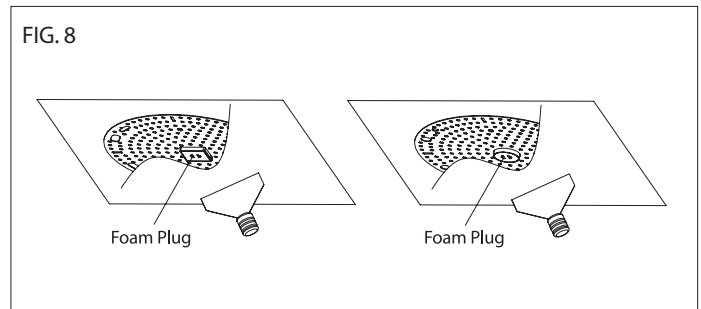

9. Paint the ceiling evenly, also covering the housing opening and plug. Gently cut through the paint along the internal edge of the round or square collar with a small knife (See **FIG. 9**).

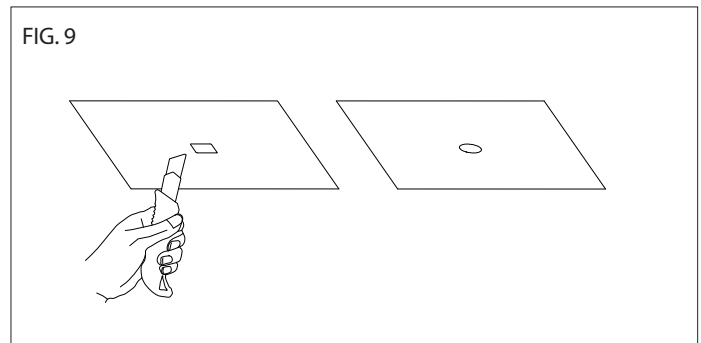

10. Grip the center of the foam plug with a pair of pointed pliers and gently pull it down to remove it from the housing collar (See **FIG. 10**).

NOTE: To achieve a sharp and clean aperture, gently remove loose paint chips and clean up small debris along the collar edge using a damp soft cloth. Touch up any uncovered surfaces along the collar edge with the ceiling paint using a small brush.

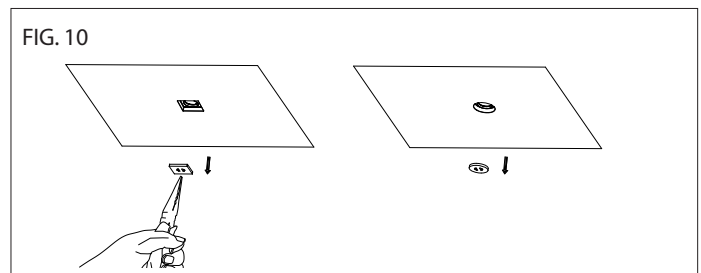

wacighting.com

Phone (800) 526.2588

Fax (800) 526.2585

Headquarters, East Manufacturing Facility

44 Harbor Park Drive

Port Washington, NY 11050

South East Manufacturing Facility

1600 Distribution Ct

Lithia Springs, GA 30122

Central Manufacturing Facility

1700 South J Elmer Freeway, Ste 100

Cedar Hill, TX 75104

West Manufacturing Facility

1750 S Archibald Ave

Ontario, CA 91761

INSTALLATION INSTRUCTION
AETHER ATOMIC - TRIMLESS ADJUSTABLE
R1ARARL, R1ASARL, R1ABFL



11. Remove the bottom cap of the Service Tool (R1A-TOOL) to expose the flat head screwdriver. Locate the adjustment slot inside the housing collar opening and insert the tip of the screwdriver inside the slot (see **FIG. 11**).

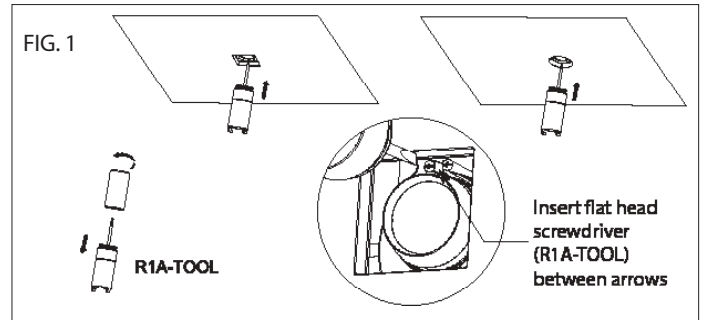

For horizontal rotation, gently twist the screwdriver inside the adjustment slot to rotate the optical assembly until the two arrows on the adjustable slot surface point in the desired direction (See **FIG. 12**).

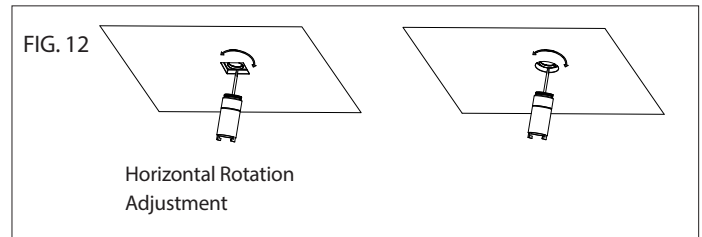

For vertical tilt, gently push the screwdriver inside the adjustment slot in the direction indicated by the two arrows until the desired tilt angle is reached (See **FIG. 11** and **FIG. 13**).

Refer to "**REFLECTOR INSTALLATION**" Section to change from pre-installed "F" (flood beam) reflector to a different reflector included with the trim package.

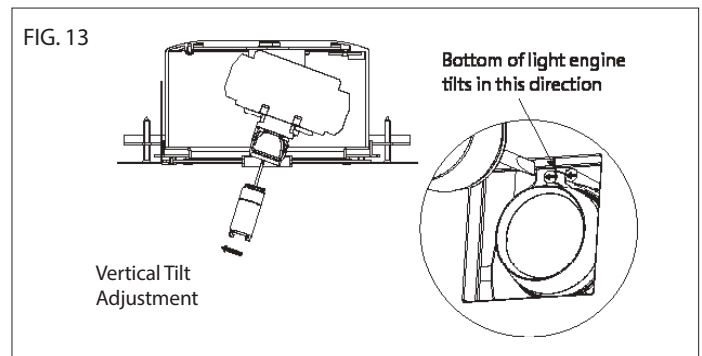

12. Install the trim by gently pushing it inside the housing collar opening. Ensure the bottom of the trim is flush with the ceiling surface (See **FIG. 14**).

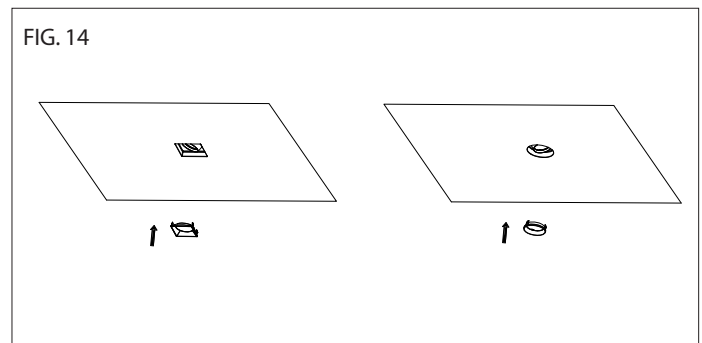

INSTALLATION INSTRUCTION

AETHER ATOMIC - TRIMLESS ADJUSTABLE

R1ARARL, R1ASARL, R1ABFL



NEW CONSTRUCTION INSTALLATION

(With Optional Frame-In Kit **R1ABFL**)

1. Install frame-in kit using two hanger bars (24" max) (See **FIG. 15**).
2. Hanger bars include a captive mounting "screw-nail" for ease of installation. Align the bottom of the hanger bar with the bottom of the wood joist. Secure the "screw-nail" on each end by screwdriver (See **FIG. 16A**), or by hammer (See **FIG. 16B**).
3. Slide fixture frame-in kit along bar hangers into desired location. Use locking screws to secure (See **FIG. 16C**).
4. To shorten hanger bars to fit in a 12" joist, snap off one section of the hanger bars (See **FIG. 17**).
5. Cut a 6" diameter hole in the drywall ceiling at the point of installation and install drywall ceiling (See **FIG. 18**).
6. Take out the housing body and connect two wire leads from the remote power supply using two WAGO connectors pre-installed on housing wire leads (See **FIG. 19**).

CAUTION: Do not power fixture with foam plug installed or damage may result. Remove plug and keep for future installation if wish to power at this step.

7. Insert the housing body inside the ceiling opening and rotate the housing until the positioning pin on the housing fits inside the rectangular cutout on the frame-in kit. Press the Trimless Frame of the housing against the ceiling and fasten four drywall screws (included with the housing) at four countersink holes (round housing, R1ARARL*) or curved slots (square housing, R1ASARL*) on the Trimless Frame to mount the housing to the ceiling (See **FIG. 20**).

Refer to Steps 7 to 12 in "**REMODEL INSTALLATION**" Section to complete installation.

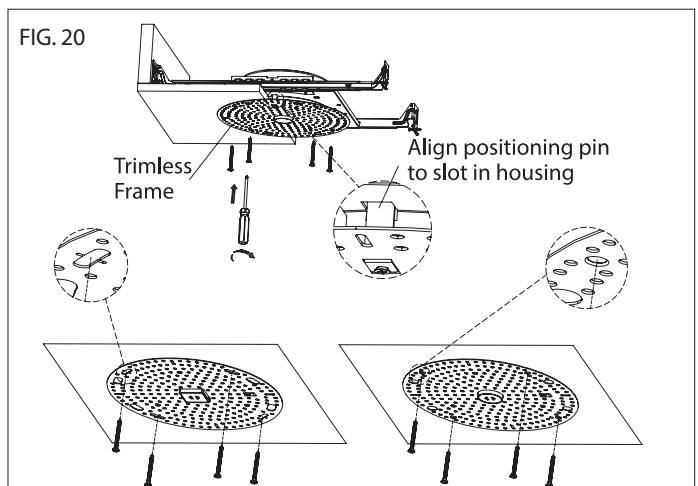
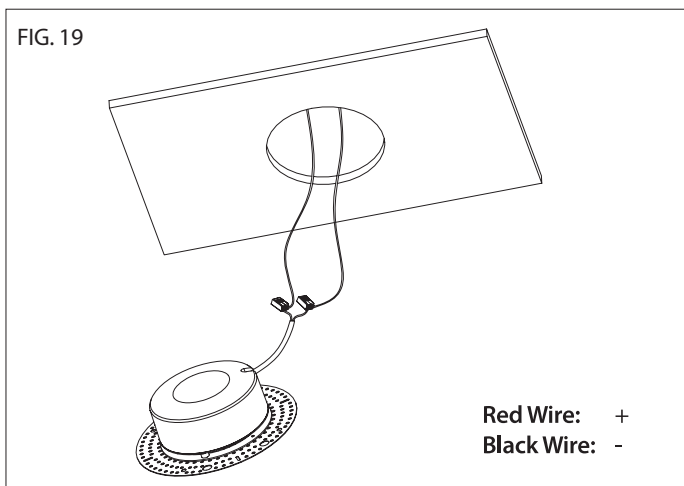
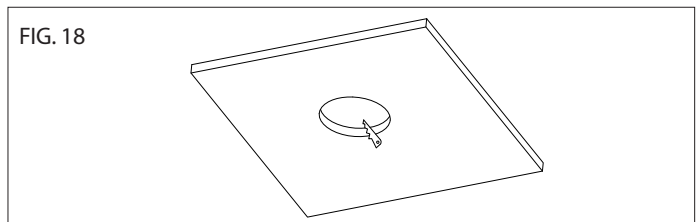
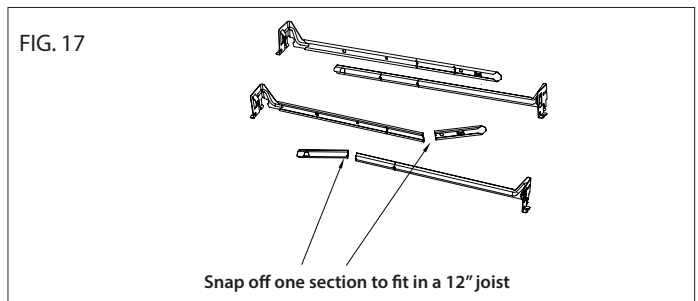
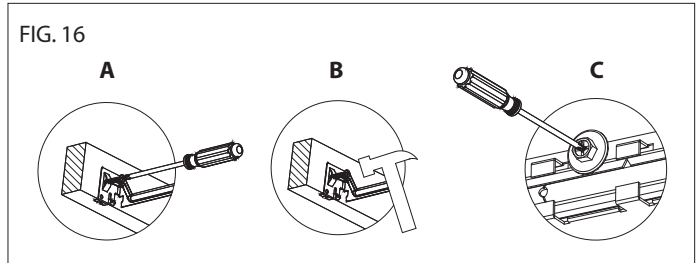
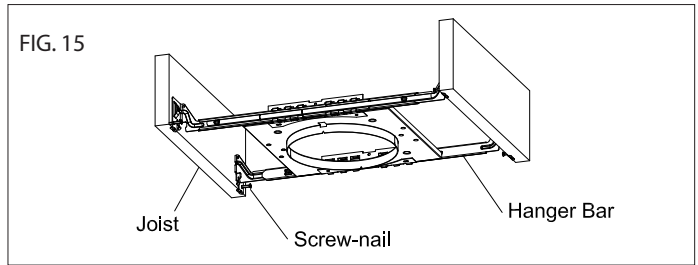

wacighting.com

Phone (800) 526.2588

Fax (800) 526.2585

Headquarters, East Manufacturing Facility

44 Harbor Park Drive

Port Washington, NY 11050

South East Manufacturing Facility

1600 Distribution Ct

Lithia Springs, GA 30122

Central Manufacturing Facility

1700 South J Elmer Freeway, Ste 100

Cedar Hill, TX 75104

West Manufacturing Facility

1750 S Archibald Ave

Ontario, CA 91761

INSTALLATION INSTRUCTION

AETHER ATOMIC - TRIMLESS ADJUSTABLE

R1ARARL, R1ASARL, R1ABFL



REFLECTOR INSTALLATION

1. Tilt the light engine assembly to vertical position using the service tool (**R1A-TOOL**) (See **FIG. 11** and **FIG.13**).
2. Screw on the bottom cap on the service tool and remove the top cylinder to expose the hook. Insert the tip of the hook inside the internal slit of the reflector holder and gently pull down the optical assembly. Disconnect the wire connector (See **FIG. 21**).
3. Use a fingernail or the flat head screwdriver of the service tool to disengage one tab of the reflector holder from the light engine. Gently separate the reflector holder from the light engine by disengaging the other tab on the opposite side (See **FIG. 22**).
4. Remove the pre-installed "F" (flood beam) reflector from the reflector holder and install the desired reflector included with the trim package.
5. Connect the optical assembly to the wire connector, using a finger to push the wire leads back into the cavity on the side of the optical assembly receptacle. Ensure that the wire leads do not tangle and block the optical assembly receptacle. Push the optical assembly through the housing collar by hand, ensuring its base fully engages with the magnet of the receptacle (See **FIG. 25**).
6. Restore the desired tilt angle using the flathead screwdriver of the service tool (See **FIG. 13**).

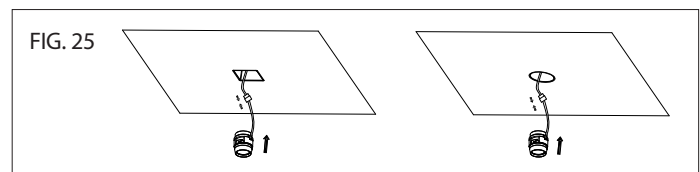
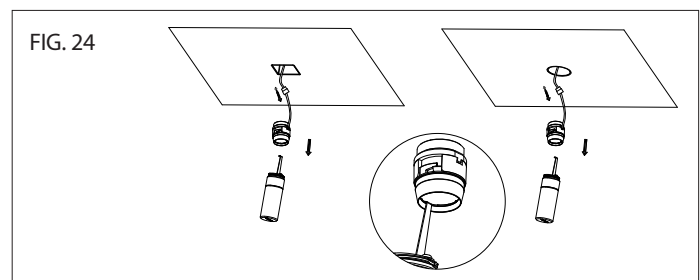
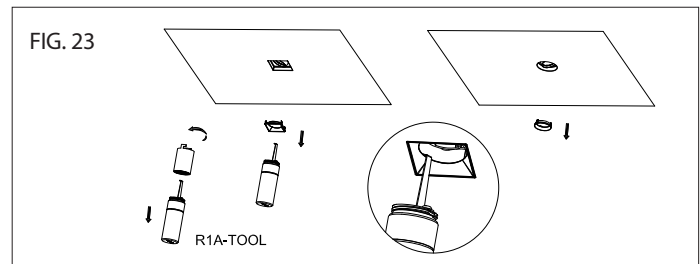
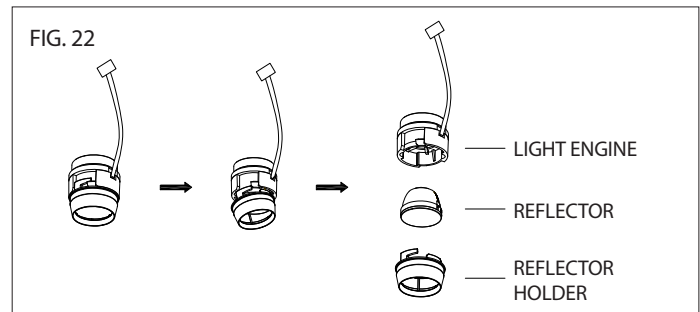
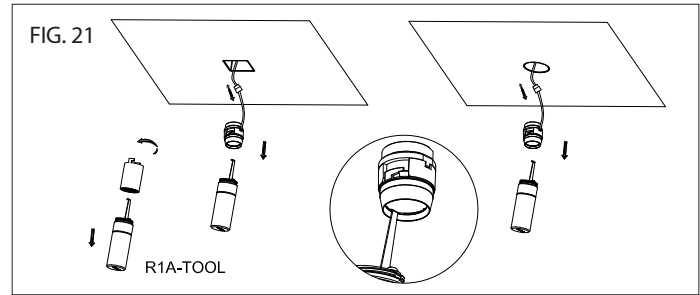

SERVICING TRIM AND LIGHT ENGINE (With Service Tool **R1A-TOOL**)

• Removing Trim

Note: Turn off power and let trim cool down before removal.
Unscrew the top cylinder of the service tool to expose the hook. Place the tip of the hook on the top edge of the trim and gently pull it down from the housing (See **FIG. 23**).

• Replacing Light Engine

1. Insert the tip of the hook inside the internal slit of the reflector holder and gently pull down the optical assembly. Disconnect the wire connector (See **FIG. 24**).
2. Use a fingernail or the flat head screwdriver of the service tool to disengage one tab of the reflector holder from the light engine. Gently separate the reflector holder from the light engine by disengaging the other tab on the opposite side (See **FIG. 22**). Replace the light engine and reinstall the reflector and its holder to the light engine.
3. Connect the optical assembly to the wire connector, use a finger to push wire leads back to the cavity of housing on side of the optical assembly receptacle. Ensure that the wire leads do not tangle and block the optical assembly receptacle. Push the optical assembly through the housing collar by hand, ensuring its base fully engages with the magnet of the receptacle (See **FIG. 25**).

REMOTE POWER SUPPLY WIRING

Refer to relative instructions of remote power supply for installation of power supply.

wacighting.com	Headquarters, East Manufacturing Facility	South East Manufacturing Facility	Central Manufacturing Facility	West Manufacturing Facility
Phone (800) 526.2588	44 Harbor Park Drive	1600 Distribution Ct	1700 South J Elmer Freeway, Ste 100	1750 S Archibald Ave
Fax (800) 526.2585	Port Washington, NY 11050	Lithia Springs, GA 30122	Cedar Hill, TX 75104	Ontario, CA 91761