

INSTALLATION INSTRUCTIONS

VENTRIX - Silo Pendant

S2PD01-1, S2PD01-2

VENTRIX
BY WAC

CAUTION: TO PREVENT ELECTRICAL SHOCK, ENSURE ELECTRICITY HAS BEEN TURNED OFF AT THE CIRCUIT BREAKER BEFORE BEGINNING.

- Read all instructions before installing.
- System is intended for installation by a licensed electrician in accordance with the National Electrical Code (NEC) and local regulations.
- When handling the fixture, do not apply pressure to the LEDs. Hold the fixture by the base only.
- Retain installation instructions for future maintenance reference.
- VENTRIX fixtures and channels feature separate data and power conductor systems. During installation and use, do not short the data or power conductors together by any means or damage may occur.

WARNING: All parts must be used as indicated in these instructions. This product is designed for use only with the supplied parts and/or accessories designated for use by WAC Lighting. Substitution of parts or accessories not designated for use with this product by WAC Lighting could result in personal injury or property damage, and will void the warranty. Contact an authorized dealer or the manufacturer if any parts are damaged or missing.

MISE EN GARDE: POUR ÉVITER TOUT CHOC ÉLECTRIQUE, ASSUREZ-VOUS QUE LE DISJONCTEUR SOIT MIS HORS TENSION AVANT DE COMMENCER.

- Lisez toutes les instructions avant l'installation.
- Le système doit être installé par un électricien licencié conformément au code national de l'électricité (NEC), et également aux règlements locaux.
- Lors de la manipulation du luminaire, n'appuyez pas sur les LED. Tenez-le uniquement par la base.

ATTENTION: Toutes les pièces doivent être utilisées comme indiqué dans ces instructions. Ce produit est conçu pour être utilisé seulement avec les pièces et/ou accessoires fournis pour être utilisés avec les produits WAC Lighting. Remplacer des pièces ou accessoires non conçus pour ce produit WAC Lighting pourrait causer des dommages corporels ou matériels et pourrait également causer l'annulation de la garantie. Veuillez contacter un revendeur autorisé ou le fabricant si des pièces manquent ou sont endommagées.

OVERALL FIXTURE DIMENSIONS

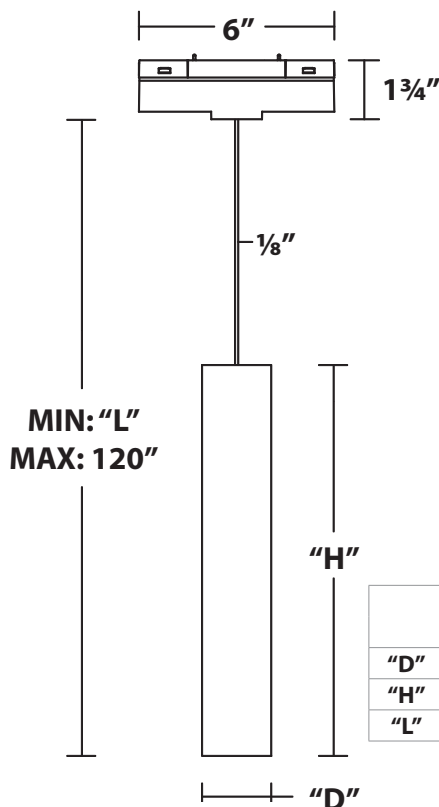

	DIMENSIONS	
	S2PD01-1	S2PD02-2
"D"	2 1/8"	2 1/2"
"H"	12"	13 1/2"
"L"	14"	16"

FIXTURE OVERVIEW

VENTRIX Silo Pendants are intended for use on WAC Lighting's VENTRIX Channel systems.

LED LUMINAIRE	VENTRIX SYSTEM
S2PD01-1, S2PD01-2	48VDC VENTRIX System

SPECIFICATIONS	
Input:	48VDC
Installation:	VENTRIX System (Ceiling Mounted in Suspended, Surface, & Recessed Profiles)
Dimming:	Via VENTRIX Connected Power Unit. Refer to CPU Specifications.

wacighting.com

Phone (800) 526.2588

Fax (800) 526.2585

Headquarters, East Manufacturing Facility

44 Harbor Park Drive

Port Washington, NY 11050

South East Manufacturing Facility

1600 Distribution Ct

Lithia Springs, GA 30122

Central Manufacturing Facility

1700 South J Elmer Freeway, Ste 100

Cedar Hill, TX 75104

West Manufacturing Facility

1750 S Archibald Ave

Ontario, CA 91761

INSTALLATION INSTRUCTIONS

VENTRIX - Silo Pendant

S2PD01-1, S2PD01-2

VENTRIX
BY WAC

PREPARATION:

1. Shut off the power at the circuit breaker and ensure adequate room to install the new fixture on the VENTRIX Channel system.
2. Carefully unpack your new fixture and lay out all the parts on a clear area. Be careful not to lose any parts necessary for installation.

FIXTURE INSTALLATION TO VENTRIX SYSTEM:

The fixture features a VENTRIX adapter for power and mechanical connection to the installed VENTRIX channel system.

1. This fixture may be installed into horizontally installed, in downward facing VENTRIX channel systems such that pendant cable can hang straight with gravity. (See **FIG. 1**).
2. Fixtures are polarity agnostic, and may be installed in VENTRIX channel in either orientation. (See **FIG. 2**).
3. Insert the adapter into the channel slot. Ensure the adapter is parallel to the channel during installation. Push the adapter into the channel until fully secured. **NOTE:** Fixture adapters also feature magnets to aid in fixture locating. (See **FIG. 3**).

CAUTION: Prior to installation in channel, clear any debris from channel bus bar and fixture, particularly on magnetic surfaces.

Any conductive elements have potential to cause electrical shorting resulting in damage.

4. Review connection, be sure both sets of locking tabs are secured in channel prior to finishing installation.

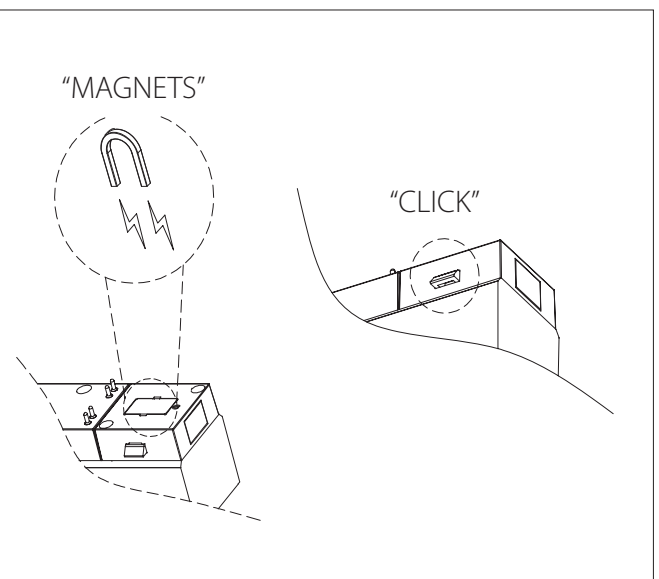
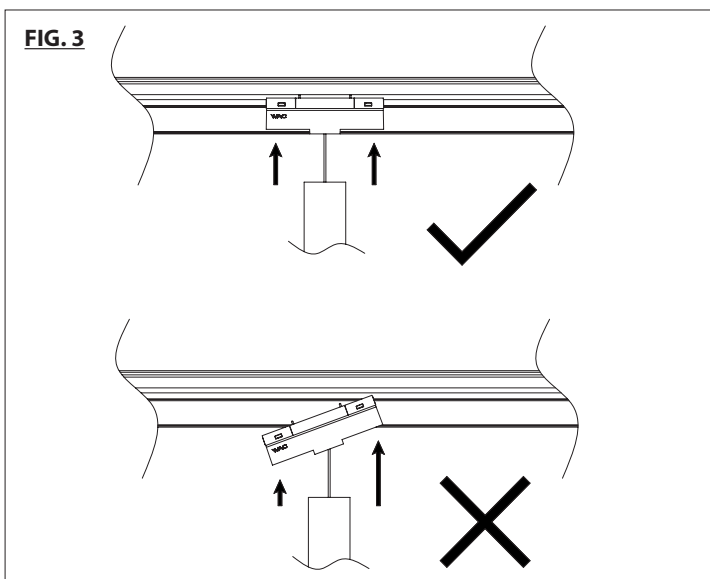
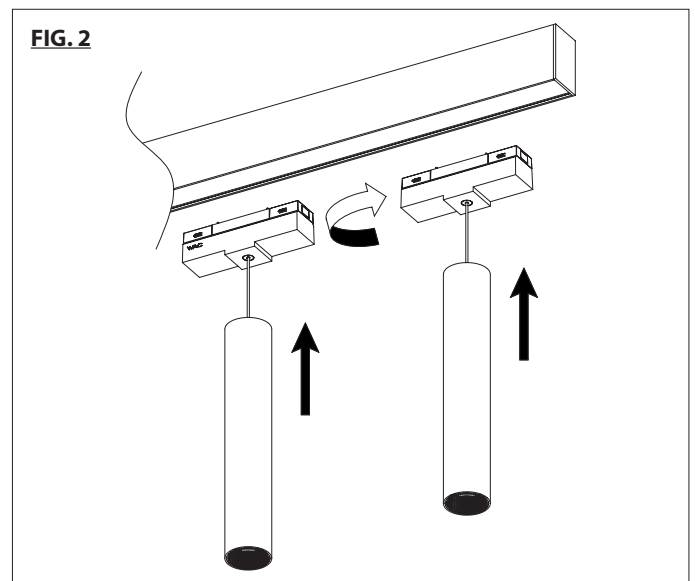
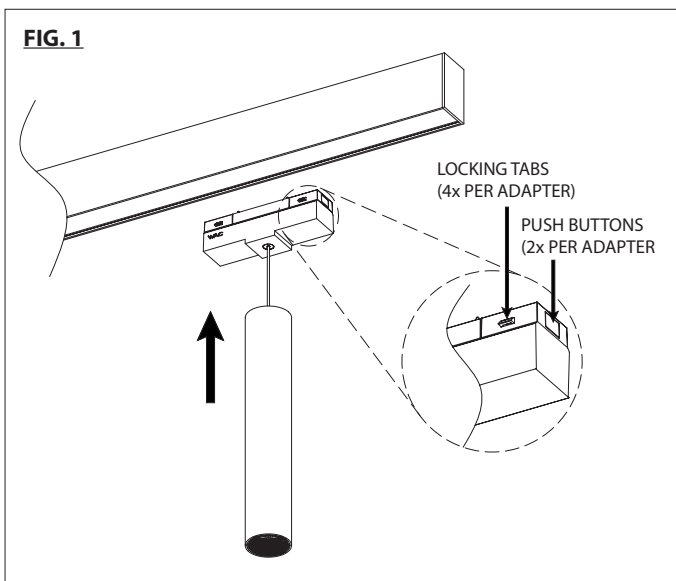

wacighting.com

Phone (800) 526.2588

Fax (800) 526.2585

Headquarters, East Manufacturing Facility

44 Harbor Park Drive

Port Washington, NY 11050

South East Manufacturing Facility

1600 Distribution Ct

Lithia Springs, GA 30122

Central Manufacturing Facility

1700 South J Elmer Freeway, Ste 100

Cedar Hill, TX 75104

West Manufacturing Facility

1750 S Archibald Ave

Ontario, CA 91761

INSTALLATION INSTRUCTIONS

VENTRIX - Silo Pendant

S2PD01-1, S2PD01-2

VENTRIX
BY WAC

RELOCATING THE FIXTURE IN CHANNEL:

While installed to the VENTRIX system, the fixture may be relocated.

1. By hand, relocate the fixture within a channel by pushing the adapter in the desired direction. (See FIG. 4).
2. Fixtures cannot be relocated between channels. It must be removed, repositioned, and then installed from one channel to another. (See FIG. 5).

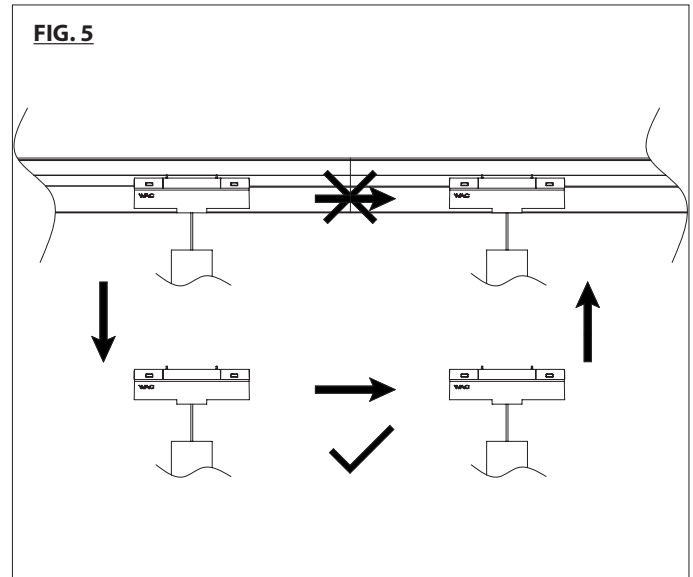
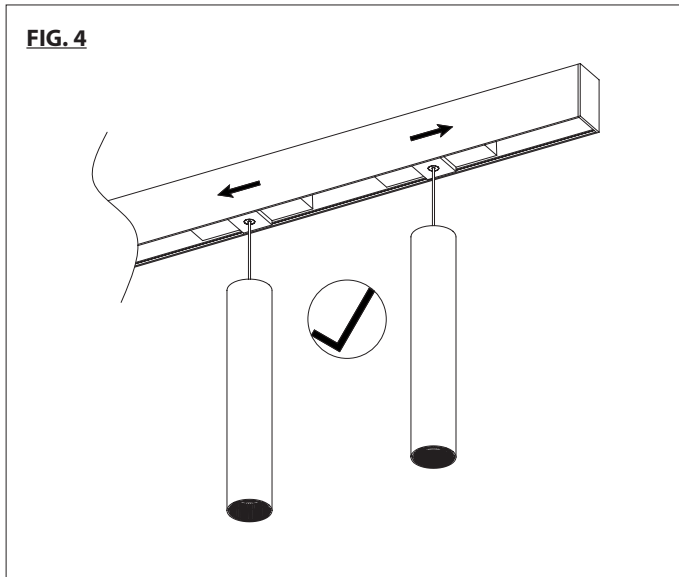

REMOVING THE FIXTURE FROM THE CHANNEL:

1. By hand, engage and press both push buttons on the adapter. While both push buttons are pressed, pull the adapter away from the channel, until the adapter is clear of the channel.
NOTE: Ensure the adapter is parallel to the channel during removal. (See FIG. 6).
2. To enable fixture removal from channel, maintain free channel space of 1.5" on each side of adapter to enable access to releasing locking tabs.

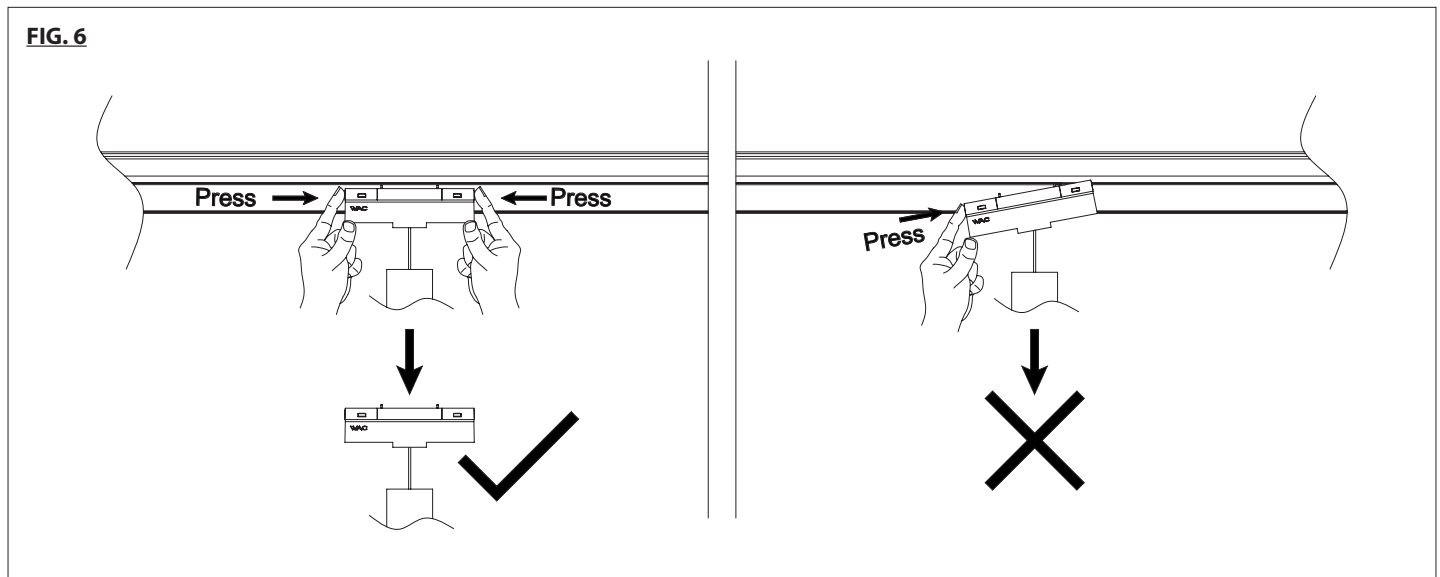

wacighting.com

Phone (800) 526.2588

Fax (800) 526.2585

Headquarters, East Manufacturing Facility

44 Harbor Park Drive

Port Washington, NY 11050

South East Manufacturing Facility

1600 Distribution Ct

Lithia Springs, GA 30122

Central Manufacturing Facility

1700 South J Elmer Freeway, Ste 100

Cedar Hill, TX 75104

West Manufacturing Facility

1750 S Archibald Ave

Ontario, CA 91761

INSTALLATION INSTRUCTIONS

VENTRIX - Silo Pendant

S2PD01-1, S2PD01-2

VENTRIX
BY WAC

ADJUSTING SUSPENSION HEIGHT:

To adjust the fixture suspension height, press the cable-gripper and (See FIG. 7)

1. Reduce the suspension height by pressing the cable-gripper and pushing the suspension cable into the fixture body.
1. Increase the suspension height by pressing the cable-gripper and pulling the suspension cable from the fixture body.

ADJUSTING SUSPENSION HEIGHT (TROUBLESHOOTING):

The fixture features a removable cap to assist with wire kinks that prevent proper suspension height adjustment (See FIG. 8).

1. Power off the fixture and allow it to cool down.
2. While holding the fixture body, use a Phillips head screwdriver, remove the two (2) fixture cap screws. Pull the fixture cap from the body.
3. Manually straighten any wire kinks and test fixture adjustment using the cable-gripper.
4. Align the fixture cap the extrusion screw holes, and secure it using the previously removed fixture cap screws.

DYNAMIC BEAM ADJUSTMENT:

The fixture features a retractable beam adjusting collar that can be rotated to change beam angles.

1. Pull to extend the beam adjusting collar below the fixture body (See FIG. 9).
2. To increase beam angle, rotate the collar counterclockwise (CCW).
3. To decrease the beam angle, rotate the collar in the clockwise (CW) direction (See FIG. 10).

After the desired beam angle is achieved, the collar may be positioned in its extended state or retracted to be flush with the base of the fixture.

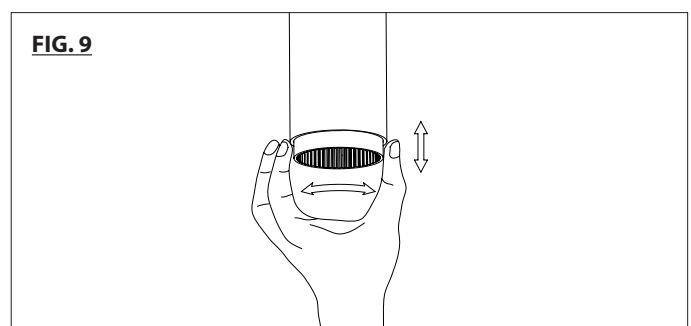
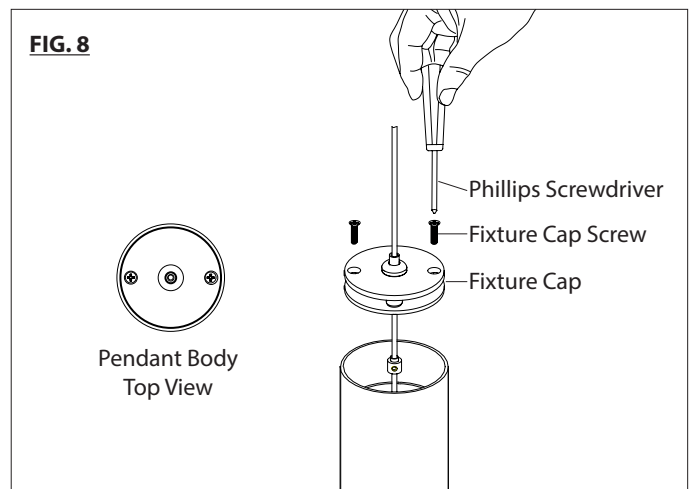
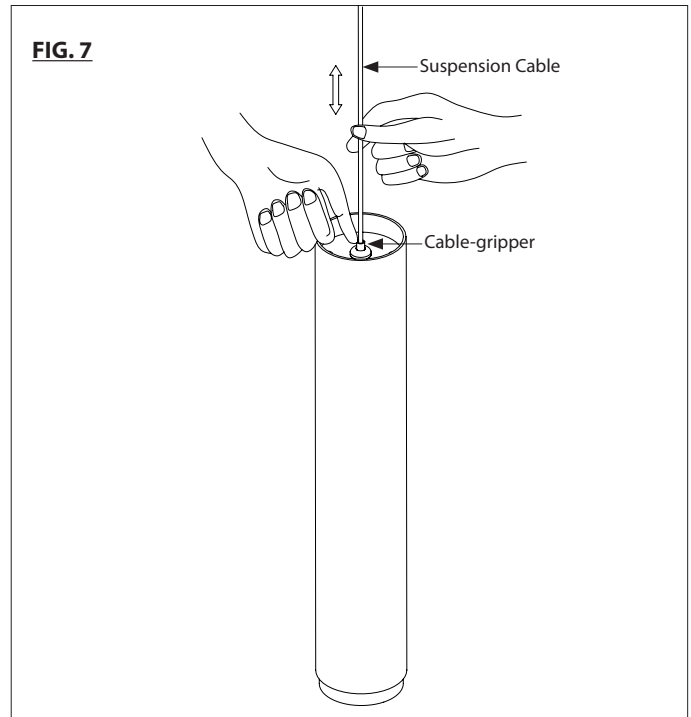
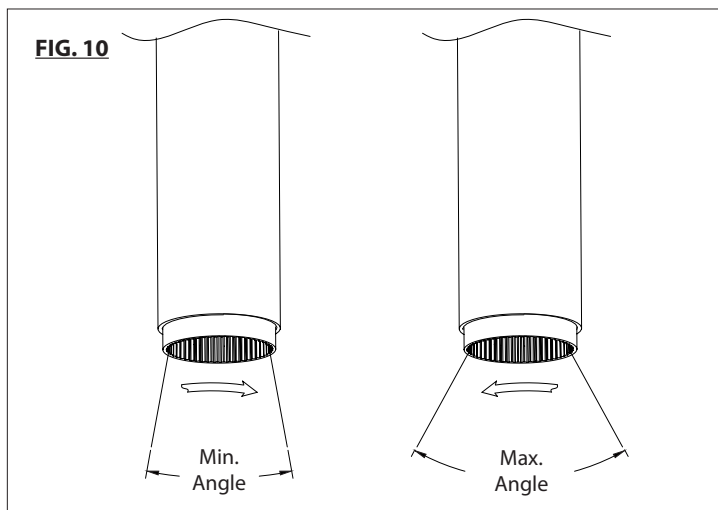

wacighting.com

Phone (800) 526.2588

Fax (800) 526.2585

Headquarters, East Manufacturing Facility

44 Harbor Park Drive

Port Washington, NY 11050

South East Manufacturing Facility

1600 Distribution Ct

Lithia Springs, GA 30122

Central Manufacturing Facility

1700 South J Elmer Freeway, Ste 100

Cedar Hill, TX 75104

West Manufacturing Facility

1750 S Archibald Ave

Ontario, CA 91761

INSTALLATION INSTRUCTIONS

VENTRIX - Silo Pendant

S2PD01-1, S2PD01-2

VENTRIX
BY WAC

REPLACING THE COLLAR (FOR SPD01-1):

The beam adjustment collar may be replaced in field to change the decorative appearance of the fixture.

1. Power off the fixture and allow it to cool down.
2. Pull the collar down to its extended position. Using additional force, continue to pull the collar to remove it from the fixture (See **FIG. 11**).
3. Align the replacement collar with the groove of the beam changing mechanism and install to fixture (See. **FIG. 12 & 13**).

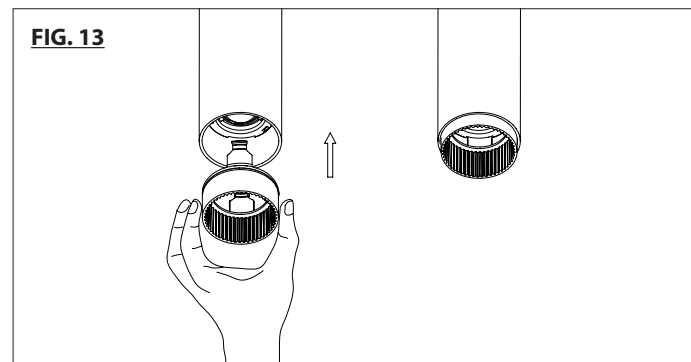
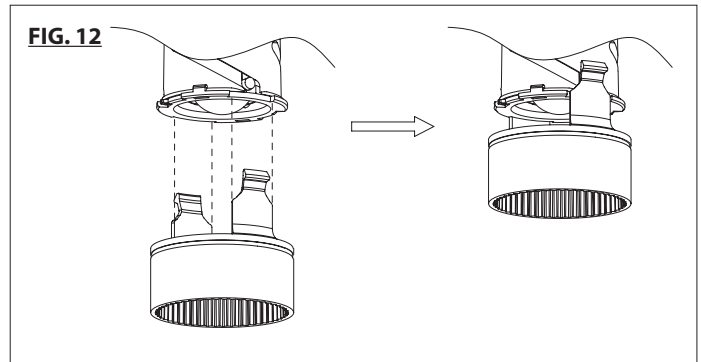
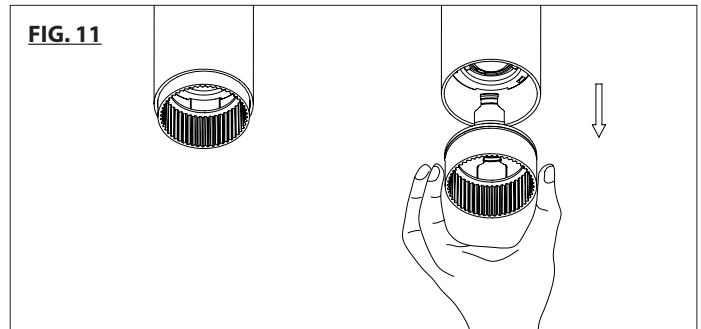

REPLACING THE COLLAR (FOR SPD01-2):

The beam adjustment collar may be replaced in field to change the decorative appearance of the fixture.

1. Power off the fixture and allow it to cool down.
2. Pull the collar down to its extended position. Using additional force, continue to pull the collar to remove it from the fixture (See **FIG. 14**).
3. Align the replacement collar with the groove of the beam changing mechanism and install to fixture (See. **FIG. 15 & 16**).

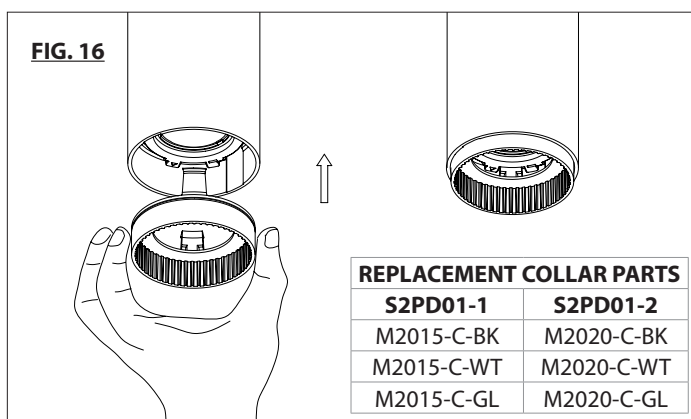
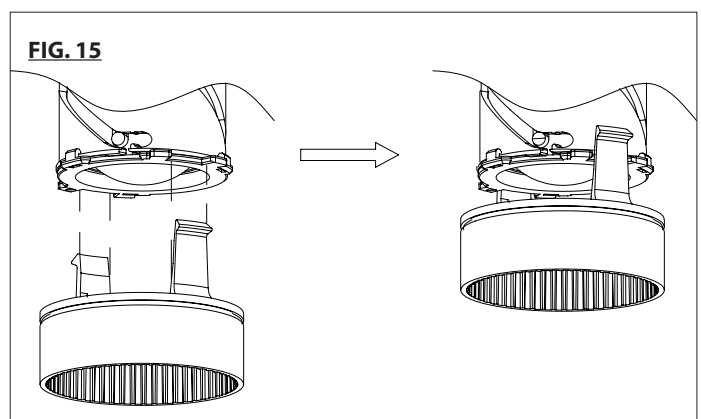
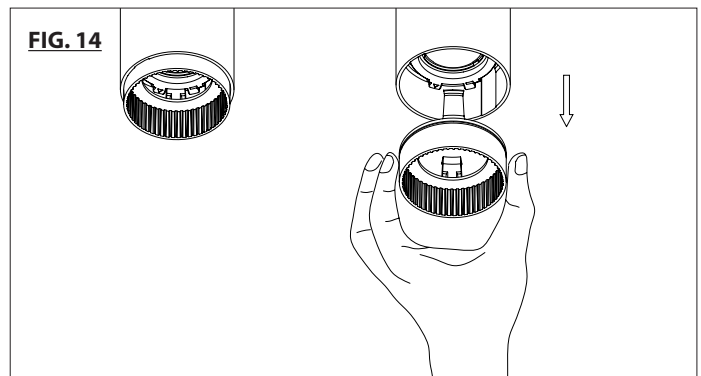

wacighting.com

Phone (800) 526.2588

Fax (800) 526.2585

Headquarters, East Manufacturing Facility

44 Harbor Park Drive

Port Washington, NY 11050

South East Manufacturing Facility

1600 Distribution Ct

Lithia Springs, GA 30122

Central Manufacturing Facility

1700 South J Elmer Freeway, Ste 100

Cedar Hill, TX 75104

West Manufacturing Facility

1750 S Archibald Ave

Ontario, CA 91761