

INSTALLATION INSTRUCTIONS

VENTRIX - Vacancy/Photo Sensor

S2SN



CAUTION: TO PREVENT ELECTRICAL SHOCK, ENSURE ELECTRICITY HAS BEEN TURNED OFF AT THE CIRCUIT BREAKER BEFORE BEGINNING.

- Read all instructions before installing.
- System is intended for installation by a licensed electrician in accordance with the National Electrical Code (NEC) and local regulations.
- Retain installation instructions for future maintenance reference.

WARNING: All parts must be used as indicated in these instructions. This product is designed for use only with the supplied parts and/or accessories designated for use by WAC Lighting. Substitution of parts or accessories not designated for use with this product by WAC Lighting could result in personal injury or property damage, and will void the warranty. Contact an authorized dealer or the manufacturer if any parts are damaged or missing.

MISE EN GARDE: POUR ÉVITER TOUT CHOC ÉLECTRIQUE, ASSUREZ-VOUS QUE LE DISJONCTEUR SOIT MIS HORS TENSION AVANT DE COMMENCER.

- Lisez toutes les instructions avant l'installation.
- Le système doit être installé par un électricien licencié conformément au code national de l'électricité (NEC), et également aux règlements locaux.

ATTENTION: Toutes les pièces doivent être utilisées comme indiqué dans ces instructions. Ce produit est conçu pour être utilisé seulement avec les pièces et/ou accessoires fournis pour être utilisés avec les produits WAC Lighting. Remplacer des pièces ou accessoires non conçus pour ce produit WAC Lighting pourrait causer des dommages corporels ou matériels et pourrait également causer l'annulation de la garantie. Veuillez contacter un revendeur autorisé ou le fabricant si des pièces manquent ou sont endommagées.

FCC RADIATION EXPOSURE STATEMENT:

This equipment complies with FCC radiation exposure limits set forth for an uncontrolled environment . This transmitter must not be co-located or operating in conjunction with any other antenna or transmitter. Any changes expressly or modifications not approved by the party responsible for compliance could void the user's authority to operate the equipment. This device complies with part 15 of the FCC Rules. Operation is subject to the following two conditions:
 (1) This device may not cause harmful interference, and
 (2) this device must accept any interference received, including interference that may cause undesired operation.

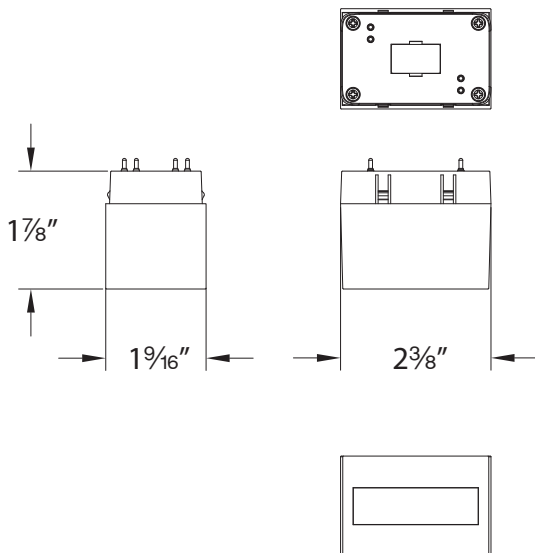

SENSOR OVERVIEW

VENTRIX Sensor is intended for use in a WAC Lighting VENTRIX installation enabling occupancy/vacancy and light harvesting capabilities.

MODEL	VENTRIX SYSTEM
S2SN-1-BK	48VDC VENTRIX System

SPECIFICATIONS	
Input:	48VDC
Installation:	VENTRIX System
Control:	Via VENTRIX Connected Power Unit. One sensor per CPU. Refer to CPU specifications.

INSTALLATION INSTRUCTIONS

VENTRIX - Vacancy/Photo Sensor

S2SN



PREPARATION:

1. Shut off the power at the circuit breaker and ensure adequate room to install the new fixture on the VENTRIX Channel system.
2. Carefully unpack your new fixture and lay out all the parts on a clear area. Be careful not to lose any parts necessary for installation.

INSTALLATION TO VENTRIX SYSTEM:

The sensor features a VENTRIX adapter for power and mechanical connection to the installed VENTRIX channel system.

1. The sensor may be installed in VENTRIX channel in either orientation. (See **FIG. 1**).
2. Insert adapter into channel slot. Ensure the adapter is parallel to the channel during installation. Push the adapter into the channel until fully secured. **NOTE:** The sensor housing should sit flush with the channel if it is installed properly. Fixture adapters also feature magnets to aid in fixture locating. (See **FIG. 2**).
3. Review connection, be sure sensor is secured in channel prior to finishing installation.
4. If removal or relocation is desired, remove from channel by gently pulling downwards. (See **FIG. 3**).
5. Commission and calibrate sensor using WAC VENTRIX app. For video instructions on how to set up daylight harvesting and occupancy/vacancy triggers, please scan the QR codes. (See **FIG. 4**).

FIG. 1

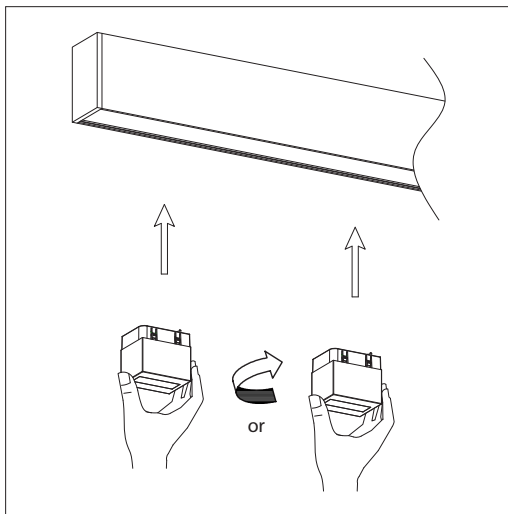

FIG. 2

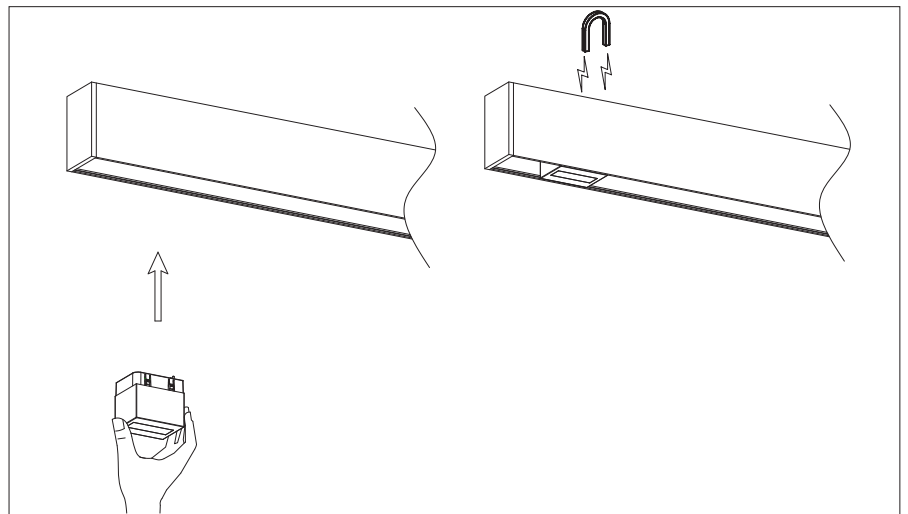

FIG. 3

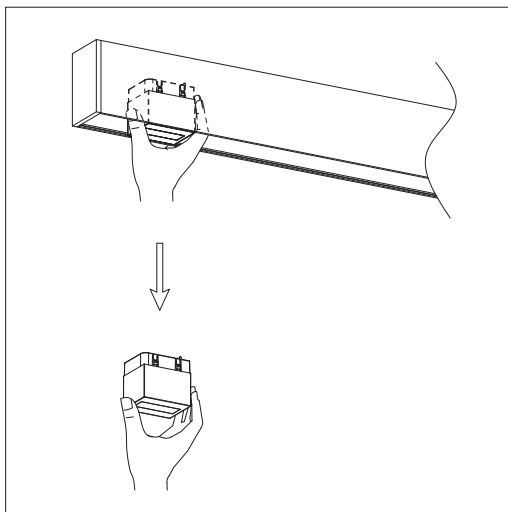

FIG. 4



Scan QR code for video instructions on setting up daylight harvesting using the photocell sensor.



Scan QR code for video instructions on setting up occupancy and vacancy triggers using the vacancy sensor.

wacighting.com

Phone (800) 526.2588

Fax (800) 526.2585

Headquarters, East Manufacturing Facility

44 Harbor Park Drive

Port Washington, NY 11050

South East Manufacturing Facility

1600 Distribution Ct

Lithia Springs, GA 30122

Central Manufacturing Facility

1700 South J Elmer Freeway, Ste 100

Cedar Hill, TX 75104

West Manufacturing Facility

1750 S Archibald Ave

Ontario, CA 91761